

# Straight push-in fitting

»metallica« series

**PLUS** ||

Art. No. 130066

Type No. 845.003-3

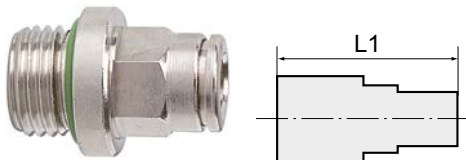

Exemplary illustration

Push-in fittings, manufactured entirely in nickel-plated brass.

All parts with a parallel thread are supplied with an FPM O-ring while the conical threads are coated with preCOTE 5 dispersion; all fittings in this series can thus also be used at high temperatures (medium compressed air).

## Technical data

Working pressure	-0.98 -16 bar
Operating temperature	-20 to 150 °C
Series	metallica
Material	nickel-plated brass
Medium	compressed air
Sealant	FKM
Sleeve	Nickel-plated brass
Clamping ring	Stainless steel
Applications	Compressed air systems, welding technology, vacuum
Recommended hose	PA, PU
Thread form	parallel male thread
Version	with O-ring
Thread	M3 ET
for tube O.D.	3 mm
L1	13.5 mm
a/f	- mm
Outer hex	without

## Commercial data

Customs tariff number	74122000
Country of origin	IT
eCl@ss 5.1.4	27294201
eCl@ss 9.0	27294201
UNSPSC_Code_v190501	27131613
UNSPSC_CodeDesc_v190501	Air coupling

## Material informations

REACH SVHC1 substance name	lead
CAS no. SVHC 1	7439-92-1
RoHS materials notice	RoHS compliant
REACH Info	contains SVHC substance

## Dimensions

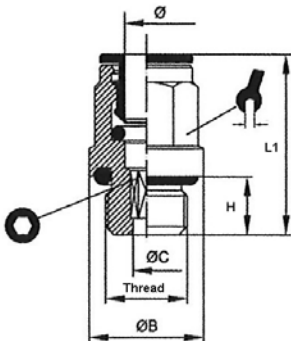

Thread	for tube O.D.	Ø B	Ø C	H	a/f	L1	
	mm	mm	mm	mm	mm	mm	mm
M3 ET	3	6.5	1.6	3.0	-	13.5	1.5