

Male connectors

»metallica« series

PLUS

Art. No. 108876

Type No. 846.014-6

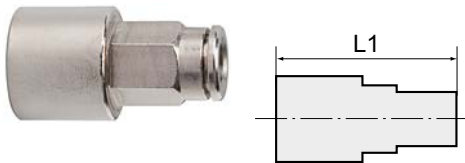

Exemplary illustration

All parts with a parallel thread are supplied with an FPM O-ring while the conical threads are coated with preCOTE 5 dispersion; all fittings in this series can thus also be used at high temperatures (medium compressed air).

Technical data

Working pressure	-0.98 - 16 bar
Operating temperature	-20 to 150 °C
Series	metallica
Material	Nickel-plated brass
Medium	Compressed air
Sealant	FKM
Sleeve	Nickel-plated brass
Clamping ring	Stainless steel
Applications	Compressed air systems, welding technology, vacuum
Recommended hose	PA and PU
Thread	G 1/4
For tube O.D.	6 mm
L1	31.0 mm
a/f	11 mm
Outer hex	with
Thread form	parallel female thread

Commercial data

Customs tariff number	74122000
Country of origin	IT
eCl@ss 5.1.4	27294201
eCl@ss 9.0	27294201
UNSPSC_Code_v190501	27131613
UNSPSC_CodeDesc_v190501	Air coupling

Material informations

REACH SVHC1 substance name	lead
CAS no. SVHC 1	7439-92-1
RoHS materials notice	RoHS compliant
REACH Info	contains SVHC substance

Dimensions

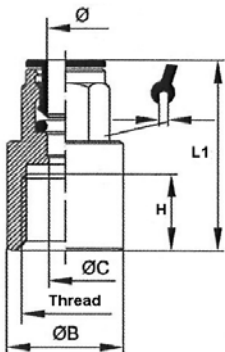

Thread	For tube O.D. mm	$\varnothing B$ mm	$\varnothing C$ mm	H mm	a/f mm	L1 mm
G 1/4	6	17.0	5.0	10.0	11	31.0

Accessories

	Art. No.	Type No.
Plug nipple »metallica«, hose exterior $\varnothing 6$, nickel-plated brass	142788	8865.006